

Cement (T) Series 水泥电阻器

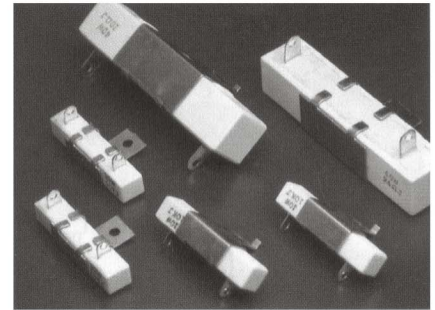

Vertical Terminal Type CQH Series

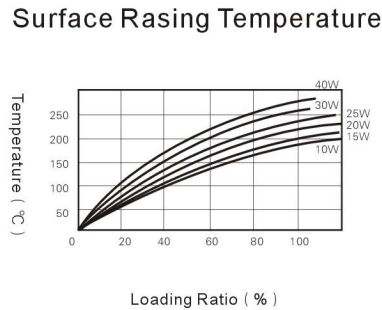
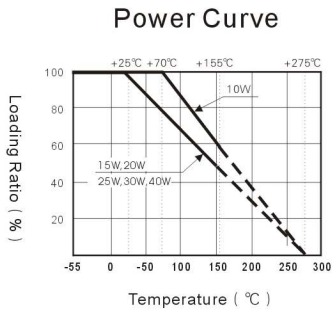
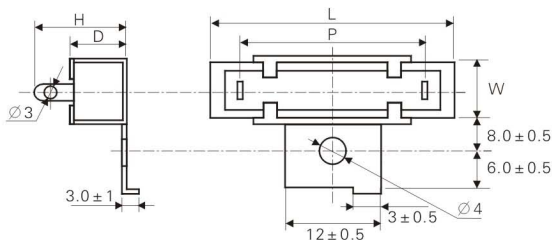

Type	Dimensions(mm)					Resistance Range	
	W±1	D±1	L±1	P±1	H±1	Wire-Wound Type	Cutting Type
CQH 10W	10	9	48	32	18	1Ω~820Ω	821Ω~1KΩ
CQH 15W	12.5	11.5	48	32	21	1Ω~1KΩ	-
CQH 20W	12.5	13.5	63	45	21	2Ω~1.2KΩ	-
CQH 30W	19	19	75	56	32	3Ω~1.5KΩ	-
CQH 40W	19	19	90	70	32	6Ω~1.5KΩ	-

Characteristics

Temperature Coefficient	<20Ω: ±400PPM/°C, ≥20Ω: ±350PPM/°C
Loading of Instantaneous	ΔR/R ≅ ±(5%+0.05Ω), No Failure
Insulation Voltage	No Failure
Strength of Lead	Pull and Bending > 1Kg, A 90° Bend at the Point of Egress, in One Direction, Return to Original Position and then A 90° Bend in Opposite Direction at the Rate of One Bend in 5 Seconds.
Resistance to Solder Heat	ΔR/R ≅ ±(1%+0.05Ω), No Failure
Solder Ability of Leads	>95%
Resistance to Solvent	No Failure
Temperature Cycle	ΔR/R ≅ ±(2%+0.05Ω), No Failure
Stable Humidity and Heat	ΔR/R ≅ ±(5%+0.05Ω), No Failure
Humidity Loading	Wire-Wound Type ΔR/R ±5%
	Cutting Type <100KΩ, ΔR/R ±5%
	Cutting Type ≥100KΩ, ΔR/R ±10%
Loading Life High Temp. Loading	Wire-Wound Type ΔR/R ±5%
	Cutting Type <100KΩ, ΔR/R ±5%
	Cutting Type ≥100KΩ, ΔR/R ±10%