

LEAD TAPING 編帶式品

- 配合自動插入機之作業，凡電容器尺寸在 $10 \times 21\text{m/m}$ 以下（特殊最大尺寸為 $16 \times 26\text{m/m}$ ）者皆可編帶。包裝分析疊式及彈帶式兩種。
- Taping capacitors for automatic insertion are available for their size up to 10×16 (max special size $16 \times 26\text{m/m}$). For packaging two types, zigzag Flat Box Called "Ammo-packaging" (TB max 10×16) and Reel (TR) are available.

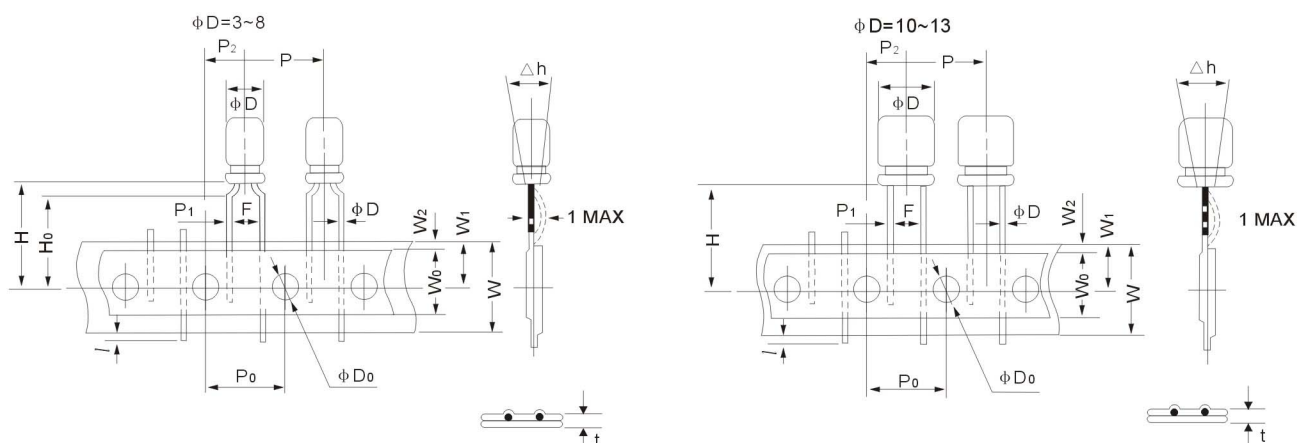

136

SPECIFICATIONS

No	Item	Symbol	Case Size								Tolerance	Remarks	
			Ø3	Ø4	Ø5	Ø6.3	Ø8	Ø10	Ø13	Ø16			
1	端子線徑 Lead Wire diameter	Ød	0.4	0.5	0.5	0.5	0.6	0.6	0.6	0.8	±0.1		
2	本體間隔 Intervals of bodies	P	12.7/25.4								±0.1		
3	打孔間隔 Intervals of punched holes	P ₀	12.7								±0.2		
4	打孔與端子線距離 Distance between holes and lead wire	P ₁	5.1	3.85(5.1)								±0.5	()Semi, standard
5	打孔與本體距離 Distance between holes and bodies	P ₂	6.35								±1.0		
6	與端子線距離 Distance between lead and lead	F	2.5	5(2.5)	5 (3.85)		5	7.5			+0.8 -0.2	()Semi, standard	
7	臺紙寬度 Base tape width	W	18.00								±0.5		
8	黏貼紙寬度 Adhesive tape width	W ₀	12.5								MAX		
9	打孔與臺紙偏差 Deviation between holes and base tape	W ₁	9.0								±0.5		
10	黏貼紙與臺紙偏差 Deviation between adhesive and base tape	W ₂	0-1.5								MAX		
11	本體下端與臺紙中心的距離 Distance between body tottom and tape center	H	17.5	18.5								±0.75	
12	端子線成型高度 Lead Wire clinched height	H ₀	16.0								±0.5		
13	端子線成突出長度 Lead Wire protrusion	l	1.0								MAX		
14	打孔孔徑 Punched hole diameter	ØD ₀	4.0								±0.3		
15	本體左右傾斜偏差 Deviation of body alignment	Δh	0								±1.0		
16	臺紙與黏貼紙之厚度 Base and adhesive tape thickness	t	0.7								±0.3		