

氣體放電管

C8G-SERIES 二級管(8.0mm)系列

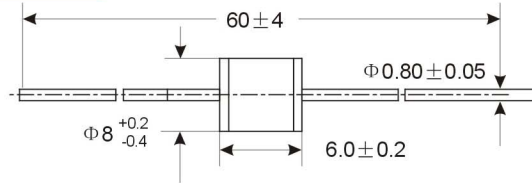

系列	DC SPARK-OVER VOLT.			IMPULSE SPARK-OVER	NOM. IMPULSE DISCHARGE CURRENT(S)	NOM. IMPULSE DISCHARGE CURRENT(L)	NOM. DISCHARGE CURRENT	INSULATION RESISTANCE		CAPCITANCE
	標稱直流擊穿電壓			衝擊擊穿電壓	耐衝擊電流	耐衝擊電流	放電電流	絕緣電阻		電容值
P/N	Vs(V)			Vis(V)	(短波)	(長波)	1sec;50Hz	Ri(Ω)		C(pF)
	Min	Typical	Max	1KV/μsec	8×20μsec	10×1000μsec		A	Min(log)	@
				Max	KA	A		ohm	V	Max
C8G60	48	60	72	600	5	50	5	9	20	2
C8G75	60	75	90	600	10	100	10	10	25	1
C8G90	72	90	108	700	10	100	10	10	50	1
C8G110	88	110	132	700	10	100	10	10	50	1
C8G150	120	150	180	700	10	100	10	10	50	1
C8G230	184	230	276	800	10	100	10	10	100	1
C8G250	200	250	300	800	10	100	10	10	100	1
C8G300	240	300	360	800	10	100	10	10	100	1
C8G350	280	350	420	900	10	100	10	10	100	1
C8G470	376	470	564	1100	10	100	10	10	250	1
C8G600	480	600	720	1300	10	100	10	10	250	1
C8G800	640	800	960	1400	10	100	10	10	500	1
C8G1000	800	1000	1200	1600	10	100	10	10	500	1

C8G series: UL-497B (Protector for data communication and fire alarm circuit)E220380: Section 1

C3LG - SERIES 三級管(7.2mm)系列

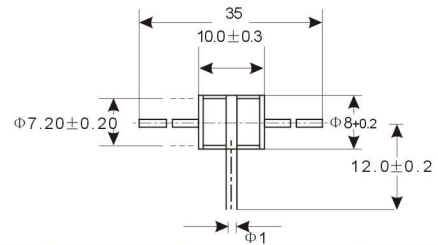
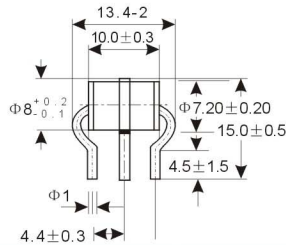

系列	DC SPARK-OVER VOLT.			IMPULSE SPARK-OVER	NOM. IMPULSE DISCHARGE CURRENT(S)	NOM. IMPULSE DISCHARGE CURRENT(L)	NOM. DISCHARGE CURRENT	INSULATION RESISTANCE		CAPCITANCE
	標稱直流擊穿電壓			衝擊擊穿電壓	耐衝擊電流	耐衝擊電流	放電電流	絕緣電阻		電容值
P/N	Vs(V)			Vis(V)	(短波)	(長波)	1sec;50Hz	Ri(Ω)		C(pF)
	Min	Typical	Max	1KV/μsec	8×20μsec	10×1000μsec		A	Min(log)	@
				Max	KA	A		ohm	V	Max
C8LG60	48	60	72	600	5	50	5	9	20	2
C8LG75	60	75	90	600	10	100	10	9	25	2
C8LG90	72	90	108	700	10	100	10	9	50	2
C8LG150	120	150	180	700	10	100	10	9	50	2
C8LG230	184	230	276	800	10	100	10	9	100	2
C8LG350	200	350	420	800	10	100	10	9	100	2
C8LG470	376	470	564	900	10	100	10	9	250	2
C8LG600	480	600	720	1200	10	100	10	9	250	2

C3LG series: UL-497B (Protector for data communication and fire alarm circuit)E220380: Section 1