

## I Series: Radial Choke Coils (工字型電感器)

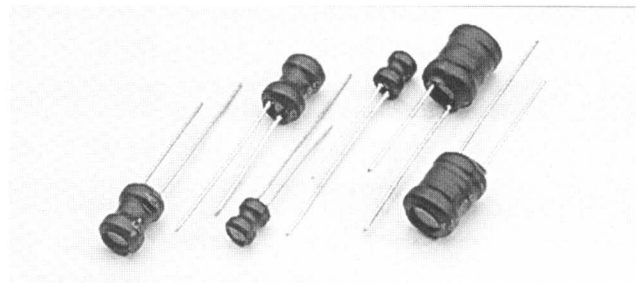

### Configuration & Dimensions:(mm)

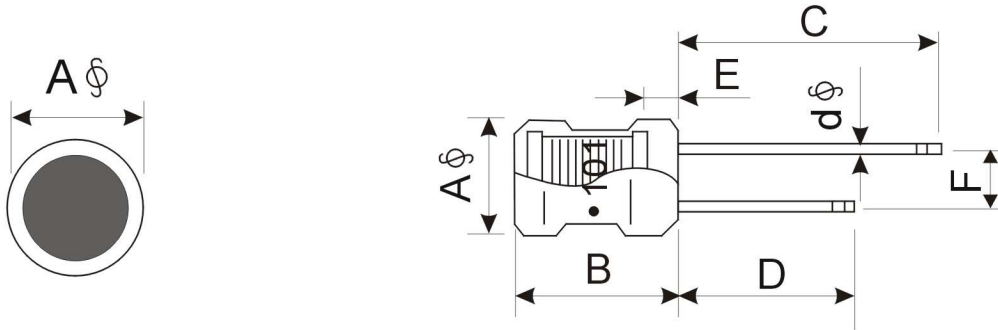

Series.	A	B	C	D	E	F	d $\phi$	Inductance Range
I0406	4.0 $\pm$ 0.5	6.5 $\pm$ 1.0	18 $\pm$ 5.0	15 $\pm$ 5.0	2.0 $\pm$ 1.0	2.0 $\pm$ 0.5	0.50 $\pm$ 0.1	1.0 $\mu$ H ... 22mH
I0507	5.0 $\pm$ 0.5	7.5 $\pm$ 1.0	18 $\pm$ 5.0	15 $\pm$ 5.0	2.0 $\pm$ 1.0	2.0 $\pm$ 0.5	0.50 $\pm$ 0.1	1.0 $\mu$ H ... 22mH
I0608	6.0 $\pm$ 0.5	8.5 $\pm$ 1.0	18 $\pm$ 5.0	15 $\pm$ 5.0	2.0 $\pm$ 1.0	2.5 $\pm$ 0.5	0.50 $\pm$ 0.1	1.0 $\mu$ H ... 33mH
I0610	6.0 $\pm$ 0.5	10.5 $\pm$ 1.0	18 $\pm$ 5.0	15 $\pm$ 5.0	2.0 $\pm$ 1.0	2.5 $\pm$ 0.5	0.50 $\pm$ 0.1	1.0 $\mu$ H ... 47mH
I0812	8.0 $\pm$ 0.5	12.5 $\pm$ 1.0	18 $\pm$ 5.0	15 $\pm$ 5.0	2.0 $\pm$ 1.0	5.0 $\pm$ 0.5	0.50 $\pm$ 0.1	2.2 $\mu$ H ... 100mH
I0912	9.0 $\pm$ 0.5	12.5 $\pm$ 1.0	18 $\pm$ 5.0	15 $\pm$ 5.0	2.0 $\pm$ 1.0	5.0 $\pm$ 0.5	0.60 $\pm$ 0.1	2.2 $\mu$ H ... 100mH
I1010	10 $\pm$ 1.0	10.5 $\pm$ 2.0	18 $\pm$ 5.0	15 $\pm$ 5.0	2.0 $\pm$ 1.0	6.0 $\pm$ 1.0	0.60 $\pm$ 0.1	4.7 $\mu$ H ... 100mH
I1012	10 $\pm$ 1.0	12.5 $\pm$ 2.0	18 $\pm$ 5.0	15 $\pm$ 5.0	2.0 $\pm$ 1.0	6.0 $\pm$ 1.0	0.65 $\pm$ 0.2	10 $\mu$ H ... 100mH
I1016	10 $\pm$ 1.0	16.5 $\pm$ 2.0	18 $\pm$ 5.0	15 $\pm$ 5.0	2.0 $\pm$ 1.0	6.0 $\pm$ 1.0	0.65 $\pm$ 0.2	0.1mH ... 220mH
I1214	12 $\pm$ 1.0	14.5 $\pm$ 2.0	18 $\pm$ 5.0	15 $\pm$ 5.0	3.0 $\pm$ 1.0	7.5 $\pm$ 1.0	0.80 $\pm$ 0.2	0.1mH ... 220mH
I1415	14 $\pm$ 1.0	15.5 $\pm$ 2.0	18 $\pm$ 5.0	15 $\pm$ 5.0	3.0 $\pm$ 1.0	7.5 $\pm$ 1.0	0.80 $\pm$ 0.2	0.1mH ... 220mH
I1618	16 $\pm$ 1.0	18.5 $\pm$ 2.0	18 $\pm$ 5.0	15 $\pm$ 5.0	3.0 $\pm$ 1.0	10.0 $\pm$ 1.0	0.85 $\pm$ 0.2	0.1mH ... 220mH
I1820	18 $\pm$ 1.0	20.5 $\pm$ 2.0	18 $\pm$ 5.0	15 $\pm$ 5.0	3.0 $\pm$ 1.0	10.0 $\pm$ 1.0	0.85 $\pm$ 0.2	0.1mH ... 220mH

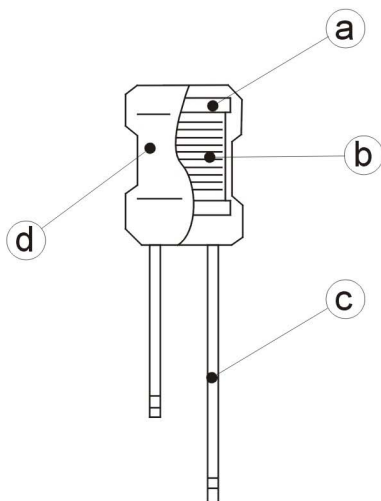

### Schematic Diagram:

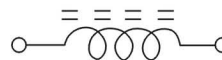

### Materials:

- a. Core : Ferrite DR core
- b. Wire : Enamelled copper wire
- c. Lead Wire : CP wire
- d. Tube : Shrinkable tube 125°C,600V

### General Specification:

- a. Storage temp : - 25°C---+85°C
- b. Operating temp : -25°C---+105°C
- c. Temp.rise : 20°C max.at rated current.